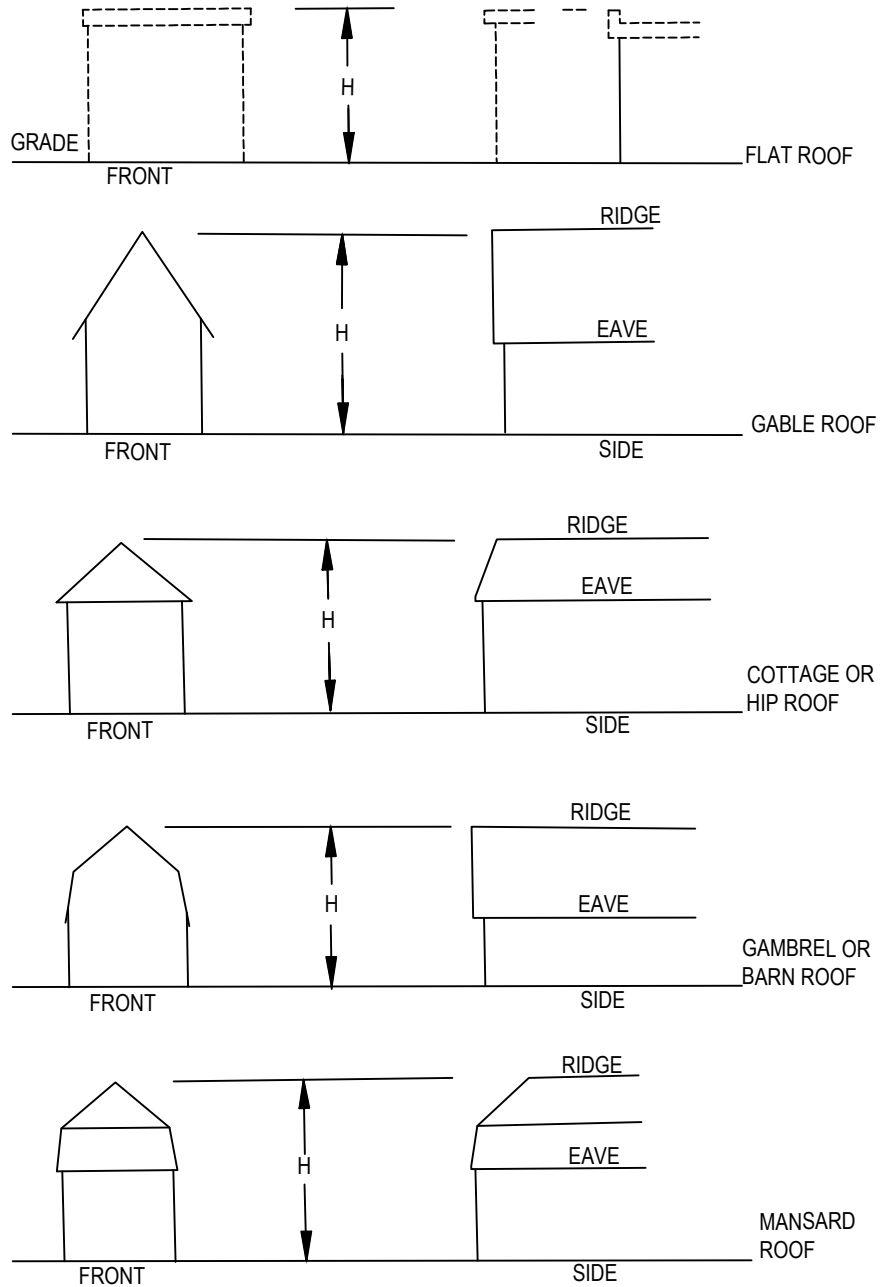

ILLUSTRATION OF BUILDING HEIGHT DEFINITIONS



H -- HEIGHT OF BUILDING

TOWN OF LINCOLN

NOTE: The above illustrations are for calculation and convenience and do not form part of this By-law.

ILLUSTRATION OF CELLAR AND BASEMENT DEFINITIONS

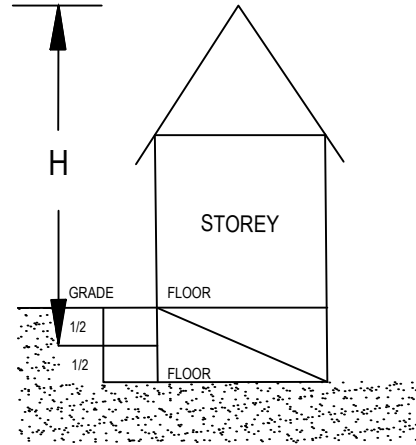
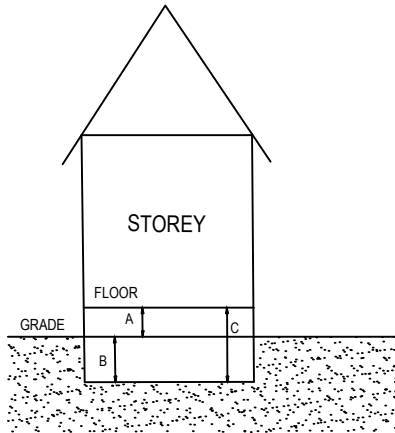

WHEN 'A' IS GREATER THAN 'B' THEN 'C' IS BASEMENT
 WHEN 'A' IS LESS THAN 'B' THEN 'C' IS A CELLAR

ILLUSTRATION OF A VISIBILITY TRIANGLE

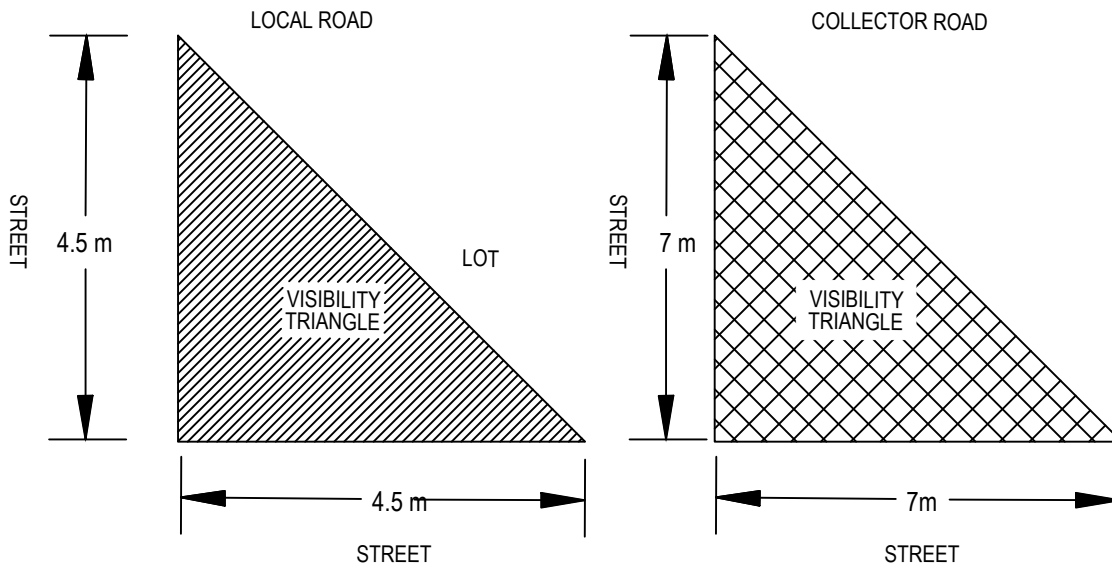

TOWN OF LINCOLN

NOTE: The above illustrations are for calculation and convenience and do not form part of this By-law.

ILLUSTRATION OF CORNER LOT

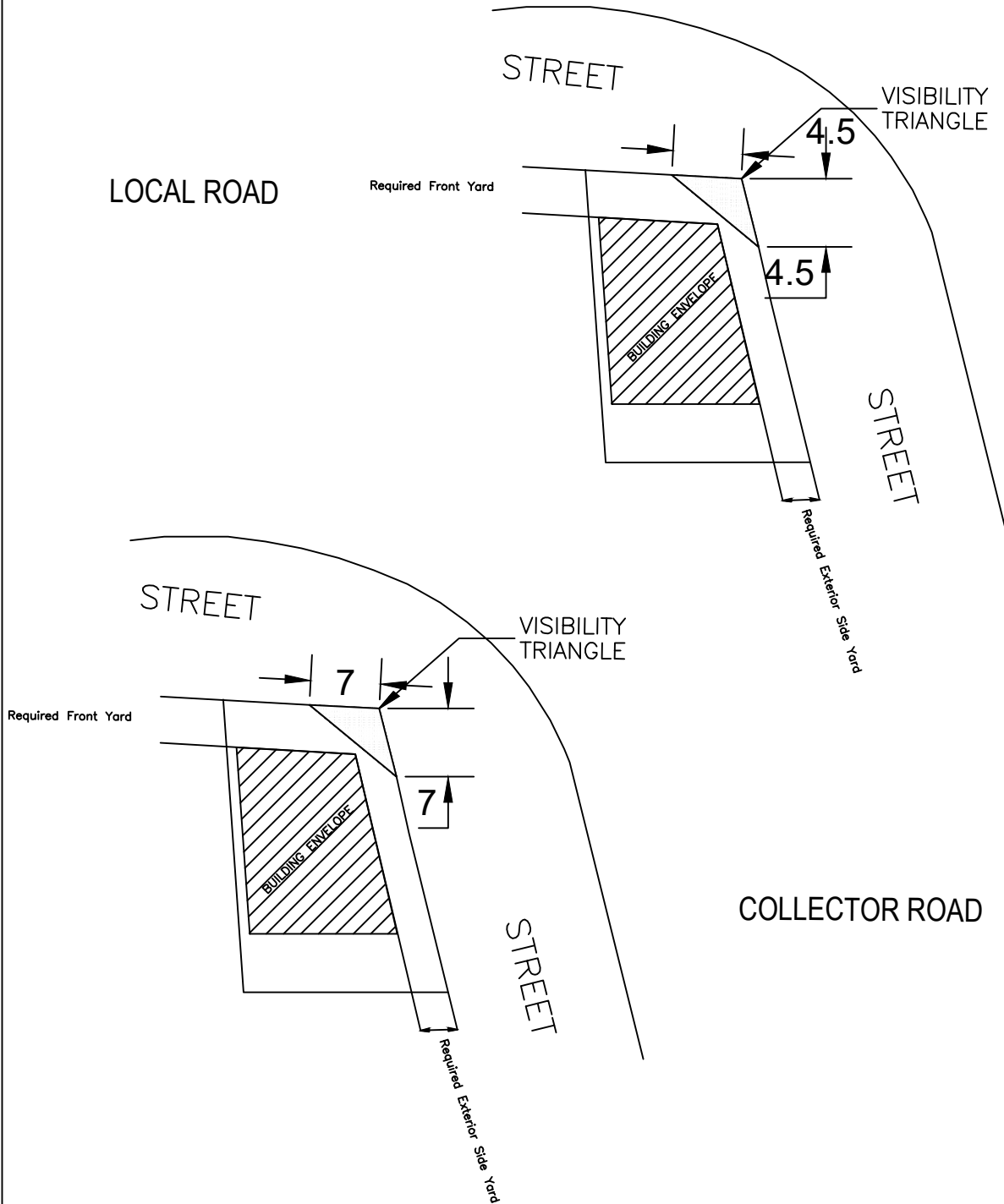

TOWN OF LINCOLN

NOTE: The above illustrations are for calculation and convenience and do not form part of this By-law.

ILLUSTRATION OF LOT DEFINITIONS

LOT FRONTAGE

WHEN SIDE LOT LINES ARE NOT PARALLEL AND THERE IS NO REAR LOT LINE; LOT FRONTAGE IS MEASURED ON A LINE PARALLEL TO AND 7.5 M BACK FROM FRONT LOT LINE

LOT FRONTAGE & DEPTH

WHERE FRONT LOT LINE IS NOT A STRAIGHT LINE

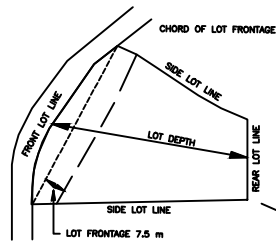

LOT FRONTAGE & DEPTH

WHERE FRONT LOT LINE IS NOT A STRAIGHT LINE

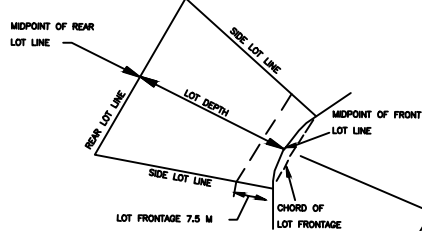

LOT DEPTH

FRONT AND REAR LOT LINES ARE NOT PARALLEL

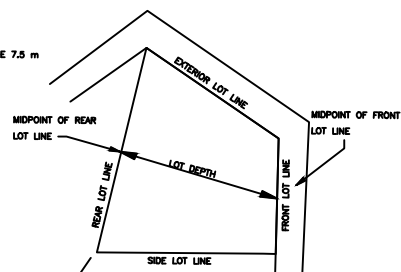

LOT DEPTH

FRONT AND REAR LOT LINES ARE PARALLEL

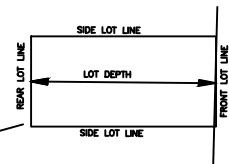

LOT, CORNER

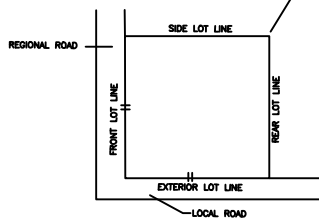
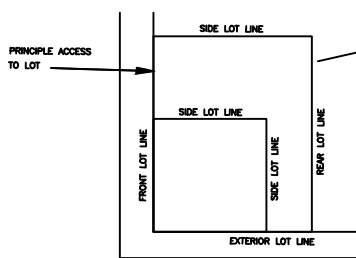

LOT, CORNER

WHEN A LOT HAS EQUAL FRONTAGE ON TWO STREETS, THE LOT LINE THAT ABUTS THE WIDER ROAD OR A REGIONAL ROAD OR A PROVINCIAL HWY SHALL BE DEEMED TO BE THE FRONT LOT LINE.

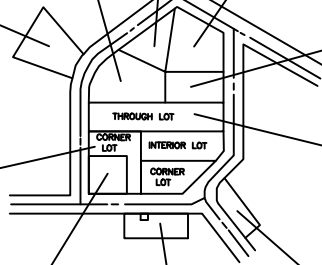

LOT, THROUGH

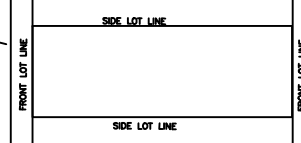

LOT, CORNER

CORNER LOT, CURVED SIDES

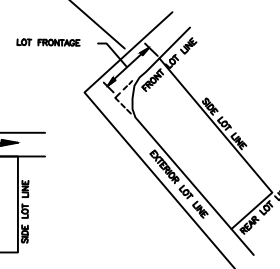

LOT FRONTAGE

FRONT LOT LINES ARE NOT CONTINUOUS

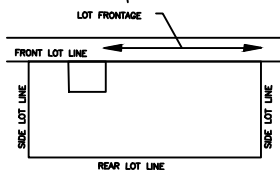

ILLUSTRATION OF LOT REQUIRED YARDS

